

# AXIOM

## WPC DOORS



# Transform Your Spaces with WPC Composite Doors

Durability Meets Elegance

Why Choose WPC Hollow Doors?

## Unmatched Durability

WPC hollow doors are highly resistant to moisture, termites, anti-bacterial and warping, ensuring they last for years without compromising on quality.



angle section photo

## Stylish Aesthetic

Available in a range of colors, textures, and finishes, WPC hollow doors bring a sleek, modern touch to any home or office.

available colors:



DW999

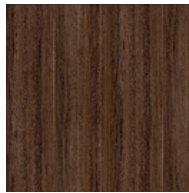

DW1002

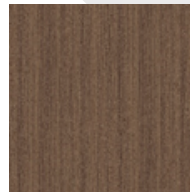

DW1013

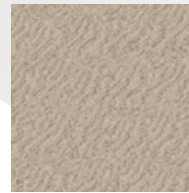

DW2014



DW2045

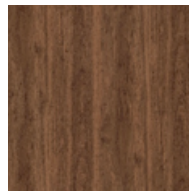

DWR574



DW110

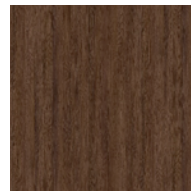

DW629

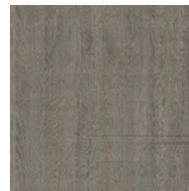

DW830

## CNC engraving door

Any shape any pattern of engraving can be customised as to your own design and style, let us know your preferred design or see some options below.

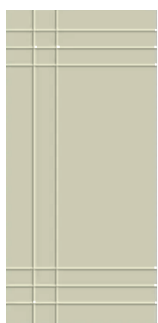

WPC - 01

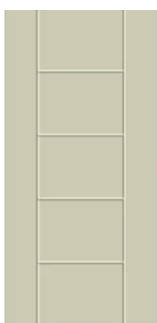

WPC - 02

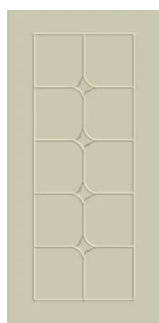

WPC - 03



WPC - 04

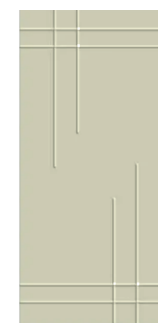

WPC - 05



WPC - 06



WPC - 07



WPC - 08

## Low Maintenance

Forget about frequent painting, polishing, or repairs. WPC hollow doors are easy to clean and maintain, unlike most doors in the market WPC doors can even be washed with water, saving you time and money.

## Weather-Resistant

These doors withstand extreme temperatures, humidity, and UV rays, making them ideal for both indoor and outdoor applications.

## Perfect for Any Space

Residential Homes: Add sophistication and practicality to bedrooms, bathrooms, and kitchens.

Commercial Spaces: Ensure a professional and polished look in offices, hotels, and retail stores.

## Customization at Its Best

We offer a variety of sizes, designs, and finishes to match your unique preferences. Whether you want a classic wooden look or a modern minimalist vibe, WPC hollow doors have you covered.



Experience the perfect combination of durability, elegance, and sustainability with WPC hollow doors. Contact us now for a free consultation or visit our website to explore our premium range.

Take a look at our product range!

### Frames:

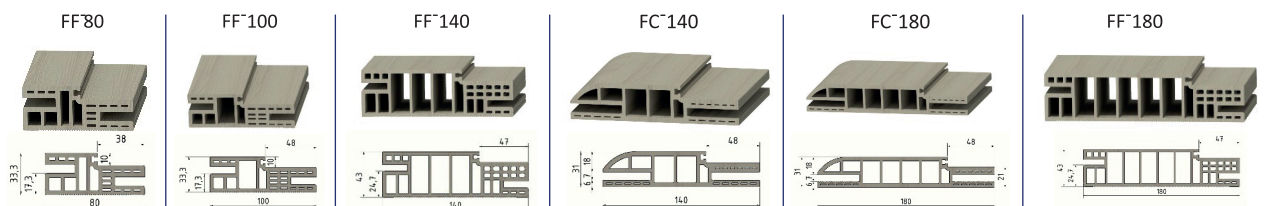

### Architrave:

AC-100

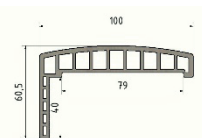

AF-80

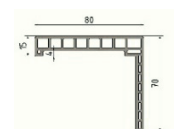

### 45mm door section:

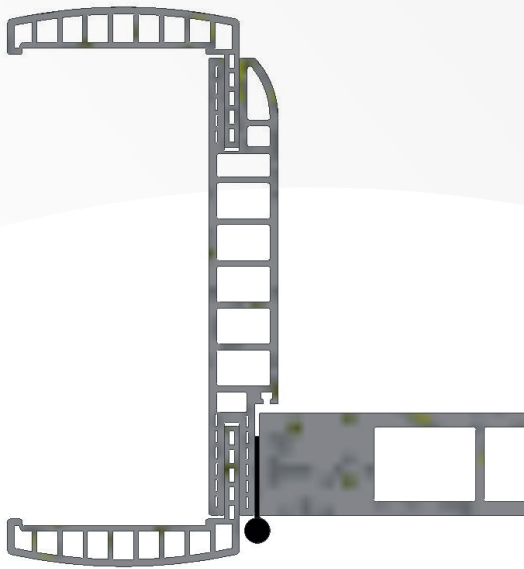

### Assembly door section:

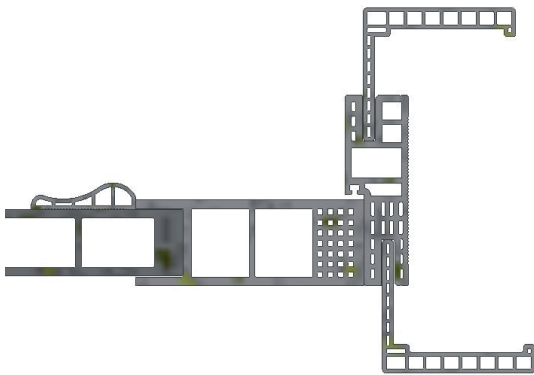

### Door Panel:

DP45-700/800/900/1000

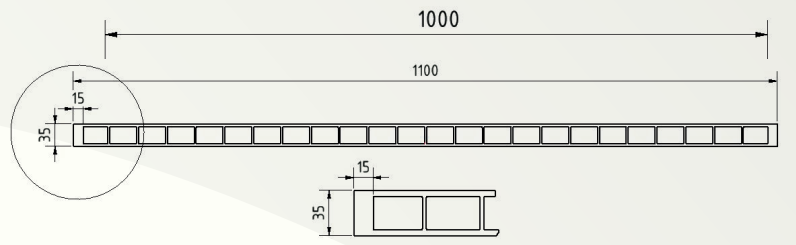

### Assembly door parts:

ADFO-120

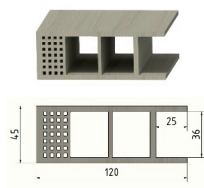

ADFI-120

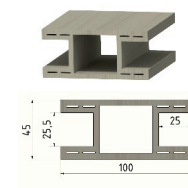

DPF-35



DPF-45

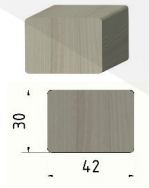

### Accessories:

GB-35

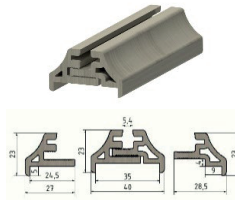

GB-45

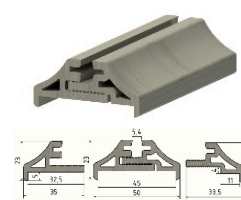

DD-60

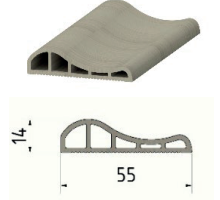

### WPC board

WPC board is a composite modern replacement to wooden boards, its completely water-proof, rigid and can be used for cladding, furniture construction, and cabinet construction.

Offers the natural look of wood or can be laminated with any of the available colors or textures. Very versatile and easy to maintain.

Thicknesses anywhere between 5mm up to 20mm and density anywhere between 0.4 to 0.7 kg/cm<sup>3</sup>

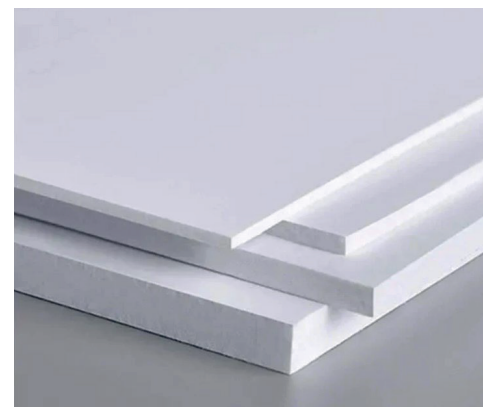

Axiom for U-PVC and WPC windows and doors  
Muwaqqar Industrial Estate, Amman, Jordan  
Tel: +962788888068

Email: [a.melhem@axiom.jo](mailto:a.melhem@axiom.jo) - [Wpc.sales@axiom.jo](mailto:Wpc.sales@axiom.jo) - [Doors.sales@axiom.jo](mailto:Doors.sales@axiom.jo)  
Website: [www.Axiom.jo](http://www.Axiom.jo)